



# PICKUP PORTS

## Outside Air (Horizontal & Vertical)



The ACI Outdoor Pickup Ports are designed to be used in conjunction with any low differential pressure transmitter (see ACI DLP or MLP Series) to provide a weatherproof outdoor reference point for monitoring building static pressure. The A/O-PUP-H is designed to be horizontally mounted with the tube in parallel with the ground or roof. The A/O-PUP-V is designed to be vertically mounted with the tube pointed downwards towards the ground or roof. When used in conjunction with a low differential pressure transmitter the pickup ports provide excellent accuracy and reliability. ACI also offers 10', 20' and 100' Medical tubing kits made of an FDA approved Food/Medical Grade PVC tubing kit. For best results, make sure that the tubing is free of dirt, dust and condensation and that you keep the tubing run as short as possible to provide

best response time. For more information regarding the Medical Grade Tubing kit, please see the specific data sheet for the Medical Grade tubing kit.

**Applications:** Indoor/Outdoor Weatherproof Pickup Port for Building Static Pressure

### PRODUCT SPECIFICATIONS

<b>Tubing Connections:</b>	Barbed fitting accepts 3/16" ID flexible Poly tubing
<b>Maximum Operating Pressure:</b>	Filter: 150 psi (10.3 bar) Medical Tubing (A/10' Tube, A/20' Tube, A/100' Tube): 65 psi maximum at 73°F (23°C)
<b>Operating Temperature Range:</b>	-22° to 185°F (-30° to 85°C)
<b>Storage Temperature Range:</b>	-40° to 185°F (-40° to 85°C)
<b>Enclosure Material   Flammability Rating:</b>	ASA/PC with UV Protectant   UL 94-V0
<b>Enclosure Color:</b>	Light Gray
<b>Filter Material:</b>	Nickel Plated Brass
<b>Product Dimensions (L x OD x H)   Weight:</b>	9.03" (11.4 cm) x 4.30" (6.99 cm) x 2.29" (5.82 cm)   0.60 lbs (0.272 kg)
<b>Agency Approvals:</b>	RoHS2, WEEE, Reach





**DIMENSIONAL DRAWING**

**Pickup Port [Horizontal]**

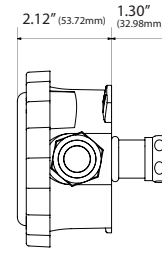
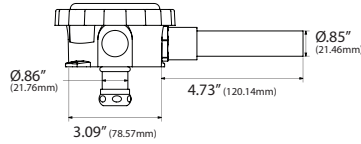
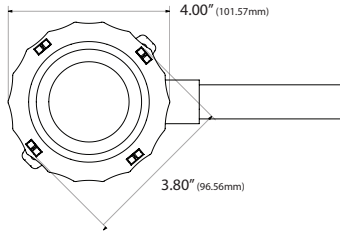

**Pickup Port [Vertical]**

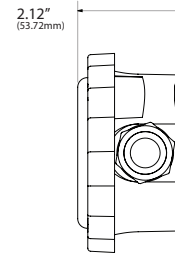
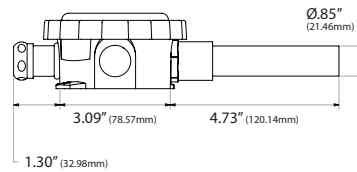
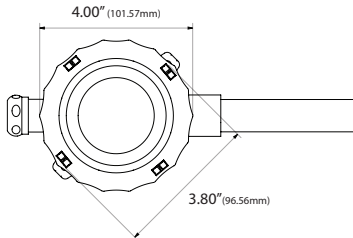

Front View

Right View

Top View

**STANDARD ORDERING**

Model # Example: **A/O-PUP-H -OR- 132892**

Model #	Item #	Description	Color
<b>A/O-PUP-H</b>	132892	Pickup Port, Horizontal Mount, Outdoor	Light Gray
<b>A/O-PUP-V</b>	132891	Pickup Port, Vertical Mount, Outdoor	Light Gray

**ACCESSORIES ORDERING**

Model # Example: **A/100'TUBE -OR- 136018**

Model #	Item #	Description	Color
<b>A/10' TUBE</b>	126606	10' Medical Tubing Kit, 1/8" ID x 1/4" OD	Clear
<b>A/20' TUBE</b>	132226	20' Medical Tubing Kit, 1/8" ID x 1/4" OD	Clear
<b>A/100' TUBE</b>	136018	100' Medical Tubing Kit, 1/8" ID x 1/4" OD	Clear

